

## HDMI 2.0 Fiber Extender Series



**Transmitter (Tx)**



**Receiver (Rx)**



**USB Power Cable**

Model: **LAN-0350**

### HDMI 2.0 Extender Over Multi-Mode 2LC Cross-Over Fiber Cable (300 Meters)

**LAN-0350** Transceiver is an HDMI optical module designed for sending HDMI 2.0 signals over incredible distances. Using multi-mode fiber optic cables to make the long distance connection, The LAN-0350 Transceiver provides full support for UHD 4K 60Hz Resolutions, color depths up to 12-bit including HDR (High Dynamic Range), HDCP (2.2 & 1.4 pass-through) and multi-channel audio.

LAN-0350 Transceiver comprises two modules, a transmitter and receiver, which supports transmission distance up to 300 meters by connecting both of the HDMI source and display (sink) ends via LC multi-mode fiber optic cable at 850nm wavelength.

LAN-0350 carries an extended cable with a type A plug for the source devices connection (e.g. Blu-ray player, DVD player, PC) and the receiver also carries an extended cable with a type A plug for the display (sink) devices connection (e.g. HDTV, UHD TV, 4K TV).

#### ※ Features

- Compliant with HDMI 2.0.
- HDCP 2.2 and HDCP 1.4 pass-through.
- Supports up to 4K2K@60Hz, YUV 4:4:4 8-bit.
- Supports up to 300 meters transmission distance over the OM3 multi-mode 2LC fiber(cross-over) cable.
- Highly resistant with EMI and RFI.
- External Power supply through micro USB cables.
- 850nm Laser Optical Transmission technology.
- Plug and play.

#### ※ Applications

- Digital home theater.
- Multiscreen splicing wall.
- High resolution video.
- Multimedia information publishing and large screen splicing system.
- Car service center with big screen video system.
- Large screen display system.
- Conference Room System.
- Medical, military image system.

#### ※ Absolute Maximum Rating

Parameter	Symbol	Min.	Typical	Max.	Unit
Bus-Power Voltage	Vcc	4.75	5.0	5.25	V
Operating Temp.	OT	-10	25	70	°C
Storage Temp.	ST	-40	25	80	°C
Relative Humidity	RH	10	40	85	RH
Ambient Temperature	TA			50	°C

Home Theater



video conference



large screen display system



Medical/military image system



## ※ Installation

1. The HDMI 2.0 Transceiver has directionality, please check the direction mark on the transceiver module before operating.
2. Connect the TX (transmitter) unit to the video source devices such as DVD, HDD, Blu-ray players and connect the RX (receiver) unit to the display devices such as HDTV, UHD TV.
3. External power supply from the micro USB cables to the transmitter and receiver than from the source and display devices is strongly recommended, as the source and display devices might go into power saving mode and leading to connection lost.

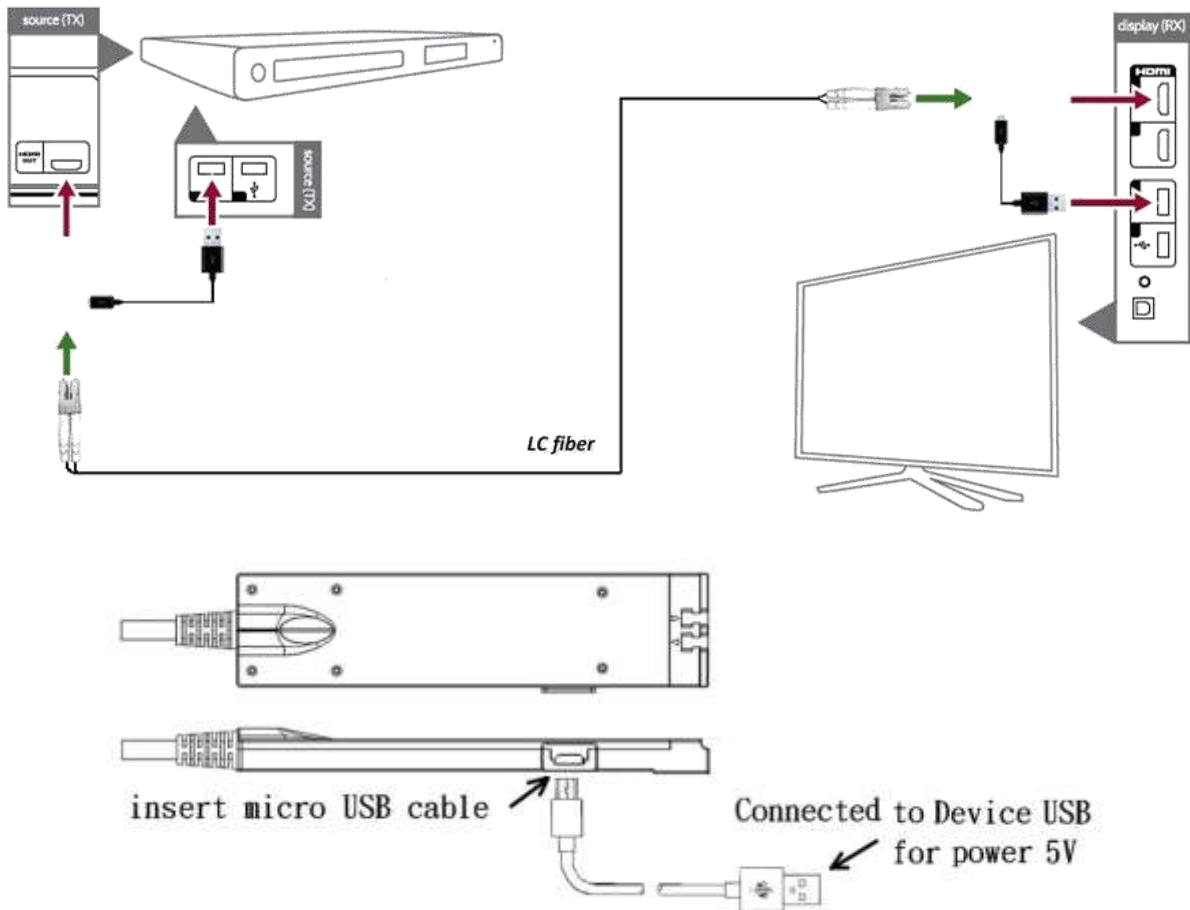

## ※ Package

